

**ADDENDUM NO. 1
TO THE
BIDDING DOCUMENTS
FOR
BID NUMBER # 23141
Mill Creek WRF WV Disinfection
Replacement**

PW# 2022.121

**FOR
LAKE COUNTY DEPARTMENT OF PUBLIC WORKS**

DATE: December 5, 2023

BIDS CLOSE: January 4, 2024, at 11:00 a.m., Local Time

TO ALL BIDDERS BIDDING ON THE ABOVE PROJECT:

All Bidders submitting a Bid on the above Contract shall carefully read this Addendum and give it consideration in the preparation of their Bid.

I. The following are revisions to the Specifications:

1. The following revisions shall be made to SECTION 01 41 00 – REGULATORY REQUIREMENTS:
 - A. Page 01 41 00-1, add the following as subparagraph 1.01.B.2.:

“2. IEPA Joint Construction and Operating Permit, No. 2023-AB-68867”
2. The following revisions shall be made to SECTION 07 46 19 – STEEL SIDING:
 - A. Page 07 46 19-1, add the following as subparagraph 1.02.D.:

“D. Submit siding sample showing style and texture to match existing siding.”
 - B. Page 07 46 19-1, delete subparagraph 2.01.A., in its entirety.
 - C. Page 07 46 19-1, delete subparagraph 2.01.B., and replace with the following:

"A. Wall panels shall be painted galvanized steel, roll formed on site. Dutchlap, 10” high with three ribs, wood grain texture. The steel shall be 24 gauge before painting with a minimum G-90 zinc coating on the top and bottom sides combined. The F_y shall equal 50 kilo pound per square inch. Weight shall be not less than 1.22 pounds per square foot.”
 - D. Page 07 46 19-1, delete subparagraph 2.01.C., and replace with the following:

“B. Color, style, size and texture of siding to match existing. Confirm with Owner.”
 - E. Page 07 46 19-1, subparagraph 2.02.B., delete the first sentence, and replace with the following:

“Corner trim shall match width of existing corner trim in each direction.”

- II. The following are revisions to the Appendix:
- A. Add the attached 10: IEPA Joint Construction and Operating Permit, No. 2023-AB-68867, as a new section to the Appendix.
- III. The following are revisions to the Drawings:
1. Sheet 25, Drawing 60-S-2: delete Drawing 60-S-2 and add a revised Drawing 60-S-2 attached to this Addenda.
 2. Sheet 27, Drawing 60-S-4: delete Drawing 60-S-4 and add a revised Drawing 60-S-4 attached to this Addenda.
 3. Sheet 28, Drawing 60-S-5: delete Drawing 60-S-5 and add a revised Drawing 60-S-5 attached to this Addenda.
 4. Sheet 29, Drawing 60-S-6: delete Drawing 60-S-6 and add a revised Drawing 60-S-6 attached to this Addenda.
- IV. Any revisions to any of the Contract Documents made by this Addendum shall be considered as the same revision to any and all related areas of the Contract Documents not specifically called out in this Addendum.
- V. The Bidder shall acknowledge receipt of this Addendum by inserting the date and number in the spaces provided in the Bid Form.

DONOHUE & ASSOCIATES, INC.
SHEBOYGAN, WISCONSIN

Nathaniel W. Cassity, P.E.

Shawn D Reimes, P.E., S.E.

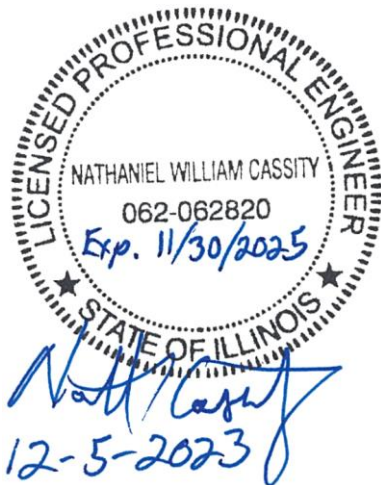

ILLINOIS ENVIRONMENTAL PROTECTION AGENCY
WATER POLLUTION CONTROL PERMIT

LOG NUMBERS: 2023-68867
BOW ID: W0978100003

PERMIT NO.: 2023-AB-68867

FINAL PLANS, SPECIFICATIONS, APPLICATION
AND SUPPORTING DOCUMENTS

DATE ISSUED: NOV 27 2023

PREPARED BY: Donohue & Associates, Inc.

SUBJECT: LAKE COUNTY PUBLIC WORKS DEPARTMENT – Mill Creek WRF UV Disinfection Replacement

PERMITTEE TO CONSTRUCT AND OWN

Lake County Department of Public Works
650 W. Winchester Road
Libertyville, Illinois 60048

Permit is hereby granted to the above designated permittee(s) to construct and/or operate water pollution control facilities described as follows:

Two banks of ultra-violet lamps with a minimum transmittance of 65% at 254 nm are proposed capable of disinfection the annual average daily flow of 0.87 MGD with one bank out of service. Each ultra-violet module will consist of quartz sleeves, an automatic chemical and/or mechanical cleaning system. Monitoring and control of ultra-violet system be conducted by a programmed logic controller. Structural modifications to the existing channel to form a properly sized channel, addition of a new level control weir, the addition of a maintenance platform, and modifications to the existing grating for installation of the new ultra-violet disinfection system. The ultra-violet channel influent gates, used to isolate each ultra-violet channel, will be removed and replaced.

The rated capacities of the above referenced treatment plant will not change as a result of these improvements.

Unless the construction for which this permit is issued has been completed, this permit will expire three years after the date of issuance.

This Permit is issued subject to the following Special Condition(s). If such Special Condition(s) require(s) additional or revised facilities, satisfactory engineering plan documents must be submitted to this Agency for review and approval for issuance of a Supplemental Permit.

SPECIAL CONDITION 1: The operational portion of this permit shall be governed by NPDES Permit No. IL0071366.

SPECIAL CONDITION 2: The Permittee to Construct shall be responsible for obtaining an NPDES Storm Water Permit prior to initiating construction if the construction activities associated with this project will result in the disturbance of one (1) or more acres total land area. Additional information is provided on the following webpage: <https://epa.illinois.gov/topics/forms/water-permits/storm-water/construction.html>

SPECIAL CONDITION 3: This permit also covers all necessary appurtenances not specifically mentioned herein but detailed in the specifications and/or the design drawings.

RECEIVED

NOV 30 2023

Lake County Public Works

THE STANDARD CONDITIONS OF ISSUANCE INDICATED ON THE REVERSE SIDE MUST BE COMPLIED WITH IN FULL. READ ALL CONDITIONS CAREFULLY.

BDF:JAR:2023-68867

DIVISION OF WATER POLLUTION CONTROL

cc: EPA-Des Plaines FOS
Records - Municipal
Donohue & Associates, Inc.



Brant D. Fleming, P.E.
Manager, Municipal Unit, Permit Section

READ ALL CONDITIONS CAREFULLY:
STANDARD CONDITIONS

The Illinois Environmental Protection Act (Illinois Revised statutes Chapter 111-12, Section 1039) grants the Environmental Protection Agency authority to impose conditions on permits which it issues.

1. Unless the construction for which this permit is issued has been completed, this permit will expire (1) two years after the date of issuance for permits to construct sewers or wastewater sources or (2) three years after the date of issuance for permits to construct treatment works or pretreatment works.
2. The construction or development of facilities covered by this permit shall be done in compliance with applicable provisions of Federal laws and regulations, the Illinois Environmental Protection Act, and Rules and Regulations adopted by the Illinois Pollution Control Board.
3. There shall be no deviations from the approved plans and specifications unless a written request for modification of the project, along with plans and specifications to the Agency and a supplemental written permit issued.
4. The permittee shall allow any agent duly authorized by the Agency upon the presentations of credentials.
 - a. To enter at reasonable times, the permittee's premises where actual or potential effluent, emission or noise sources are located or where any activity is to be conducted pursuant to this permit;
 - b. To have access to and copy at reasonable times any records required to be kept under the terms and conditions of this permit;
 - c. To inspect at reasonable times, including during any hours of operation of equipment constructed or operated under this permit, such equipment or monitoring methodology or equipment required to be kept, used, operated, calibrated, and maintained under this permit;
 - d. To obtain and remove at reasonable times samples of any discharge or emission of pollutants;
 - e. To enter at reasonable times and utilize any photographic, recording, testing, monitoring, or other equipment for the purpose of preserving, testing, monitoring, or recording any activity, discharge, or emission authorized by this permit;
5. The assurance of this permit:
 - a. Shall not be considered as in any manner affecting the title of the premises upon which the permitted facilities are to be located;
 - b. Does not release the permittee from any liability for damage to person or property caused by or resulting from the construction, maintenance, or operation of the proposed facilities;
 - c. Does not release the permittee from compliance with other applicable statutes and regulations of the United States, of the State of Illinois, or with applicable local laws, ordinances, and regulations;
 - d. Does not take into consideration or attest to the structural stability of any units or parts of the project;
 - e. In no manner implies or suggests that the Agency (or its offices, agents, or employees) assumes any liability, directly or indirectly, for any loss due to damage, installation, maintenance, or operation of the proposed equipment or facility;
6. Unless a joint construction/operation permit has been issued, a permit for operating shall be obtained from the Agency before the facility or equipment covered by this permit is placed into operation.
7. These standard conditions shall prevail unless modified by special conditions.
8. The Agency may file a complaint with the Board for suspension or revocation of a permit;
 - a. Upon discovery that the permit application contained misrepresentations, misinformation, or false statement or that all relevant facts were not disclosed; or
 - b. Upon finding that any standard or special conditions have been violated; or
 - c. Upon any violation of the Environmental Protection Act or any Rules or Regulation effective thereunder as a result of the construction or development authorized by this permit.

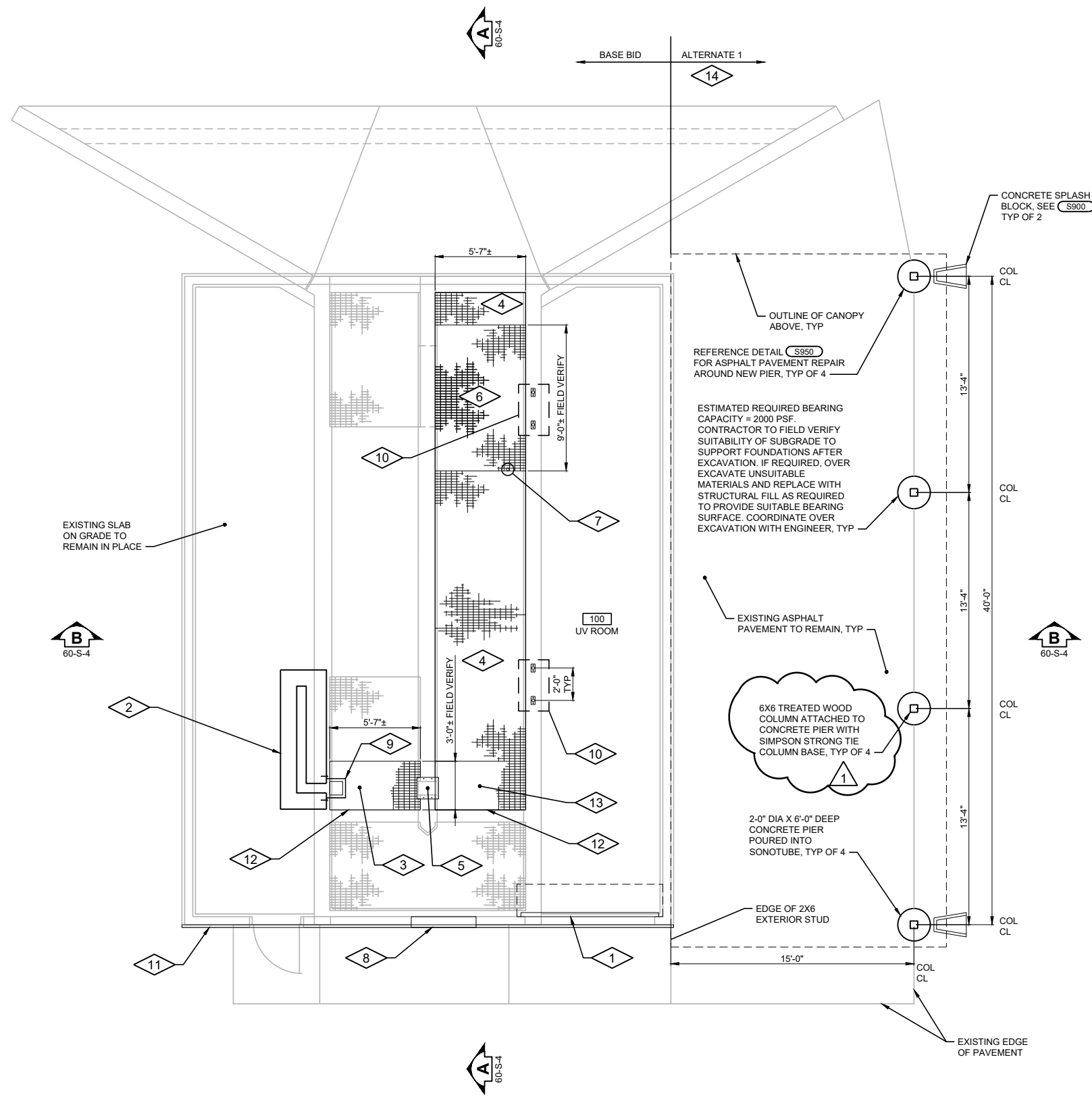

GENERAL NOTES:

1. CONTRACTOR TO FIELD VERIFY EXISTING CONDITIONS, DIMENSIONS, AND ELEVATIONS PRIOR TO CONSTRUCTION AND/OR FABRICATION.
2. REFER TO 001 SERIES OF DRAWINGS FOR THE SPACE ENVIRONMENT/HAZARDOUS RATING SCHEDULE REGARDING ENVIRONMENTAL CONDITIONS ANTICIPATED WITHIN EACH SPACE AND ALLOWABLE MATERIALS OF CONSTRUCTION TO BE USED WITHIN EACH SPACE.

PLAN NOTES:

1. DOOR D01 - OVERHEAD COILING DOOR W/ MOTOR OPERATOR
 - SEE SPECIFICATION SECTION 08 33 23 FOR DETAILS.
 - DOOR SIZE: 8'-0" WIDE X 9'-0" HIGH. FIELD VERIFY EXISTING OPENING SIZE PRIOR TO FABRICATION.
 - COLOR OF DOOR IS TO MATCH GREEN COLOR OF OVERHEAD DOORS ON ALL OTHER BUILDINGS ON SITE. FIELD VERIFY COLOR PRIOR TO FABRICATION. CONFIRM WITH OWNER.
 - PROVIDE BRAKE FORM ALUMINUM TRIM AROUND EXISTING OPENING AS REQUIRED IN ORDER TO PROVIDE A COMPLETE INSTALLATION.
 - PROVIDE WOOD BLOCKING AT INTERIOR SIDE OF ROOM AS REQUIRED TO INSTALL COILING DOOR HOOD AND TRACK.
2. EQUIPMENT PAD WITH SERVICE TROUGH. COORDINATE WITH MANUFACTURER ON LOCATION AND SIZE OF TROUGH PRIOR TO PLACING CONCRETE. SEE (S343)
3. NEW AL GRATING. PROVIDE OPENING IN GRATING AS REQUIRED FOR UV CABLES. COORDINATE SIZE AND LOCATION OF OPENING WITH UV MANUFACTURER. GRATING MANUFACTURER TO PROVIDE LOAD CARRYING BANDING AROUND OPENING. GRATING DEPTH SHALL MATCH EXISTING GRATING DEPTH. FIELD VERIFY WIDTH OF GRATING REQUIRED SO THE GRATING SECTION DOES NOT INTERFERE WITH NEW GATE FRAME.
4. REINSTALL SALVAGED GRATING AFTER UV EQUIPMENT INSTALLATION HAS BEEN COMPLETED. DO NOT REINSTALL GRATING HOLD DOWN CLIPS. TURN CLIPS OVER TO OWNER.
5. 16" X 16" X 1/4" THICK STAINLESS STEEL PLATE OVER UV CABLE PASSAGE OPENING. ANCHOR TO CONCRETE WITH (4)-3/8" DIA COUNTERSUNK SS ANCHORS.
6. NEW AL GRATING. PROVIDE 3 SEPARATE GRATING SECTIONS. DO NOT INSTALL HOLD DOWN CLIPS. TURN CLIPS OVER TO OWNER. GRATING DEPTH SHALL MATCH EXISTING GRATING DEPTH. FIELD VERIFY.
7. HOLE IN GRATING FOR LEVEL SENSOR WIRING. COORDINATE LOCATION WITH GRATING MANUFACTURER. HOLE SHALL HAVE BANDING AROUND PERIMETER.
8. NEW OPENING IN EXTERIOR WALL FOR LOUVER. PROVIDE NEW HEADER, JAMBS AND SILL AROUND OPENING. FLASH ENTIRE EXTERIOR PERIMETER OF NEW OPENING AND PROVIDE SEALANT. COLOR OF FLASHING TO BE WHITE TO MATCH EXISTING STEEL SIDING. SEE H DRAWINGS FOR ADDITIONAL DETAILS.
9. STAINLESS STEEL UV CABLE TRAY, SEE (S353)
10. AL RAILING GRAB POSTS FOR LADDER ENTRY TO MAINTENANCE PLATFORM BELOW. MOUNT SET OF POSTS APART 2'-0" OC AND CENTER OVER LADDER BELOW. CONFIRM FINAL MOUNTING LOCATION WITH OWNER. SEE (S531)
11. NEW HORIZONTAL STEEL SIDING ON LOWER HALF OF SOUTH FACE OF BUILDING. SEE SOUTH ELEVATION ON SHEET 60-S-6 FOR DETAILS.
12. GRATING SUPPORT IN FRONT OF GRATE FRAME, SEE (S542)
13. NEW AL GRATING. DO NOT INSTALL HOLD DOWN CLIPS. TURN CLIPS OVER TO OWNER. GRATING DEPTH SHALL MATCH EXISTING GRATING DEPTH. FIELD VERIFY WIDTH OF GRATING REQUIRED SO THE GRATING SECTION DOES NOT INTERFERE WITH NEW GATE FRAME.
14. IF OWNER ACCEPTS ALTERNATE 1, PROVIDE ALL WORK ASSOCIATED WITH CANOPY ON EAST SIDE OF BUILDING.

Revision Number	Revision Description	Checked By	Date
01	ADDENDUM NO. 1	WJR	12/05/2023

Designed By	CDP
Drawn By	CDP
Checked By	SDR
Approved By	SDR
Filename	60SP1.DWG
Project No.	14206
Project Date	OCT 2023

LAKE COUNTY DEPT. OF PUBLIC WORKS
MILL CREEK WRF
UV DISINFECTION REPLACEMENT
OLD MILL CREEK, IL
UV DISINFECTION BUILDING
PLAN



Sheet No. 25
Drawing No.

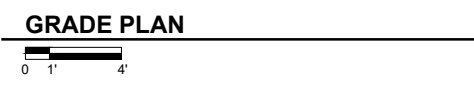

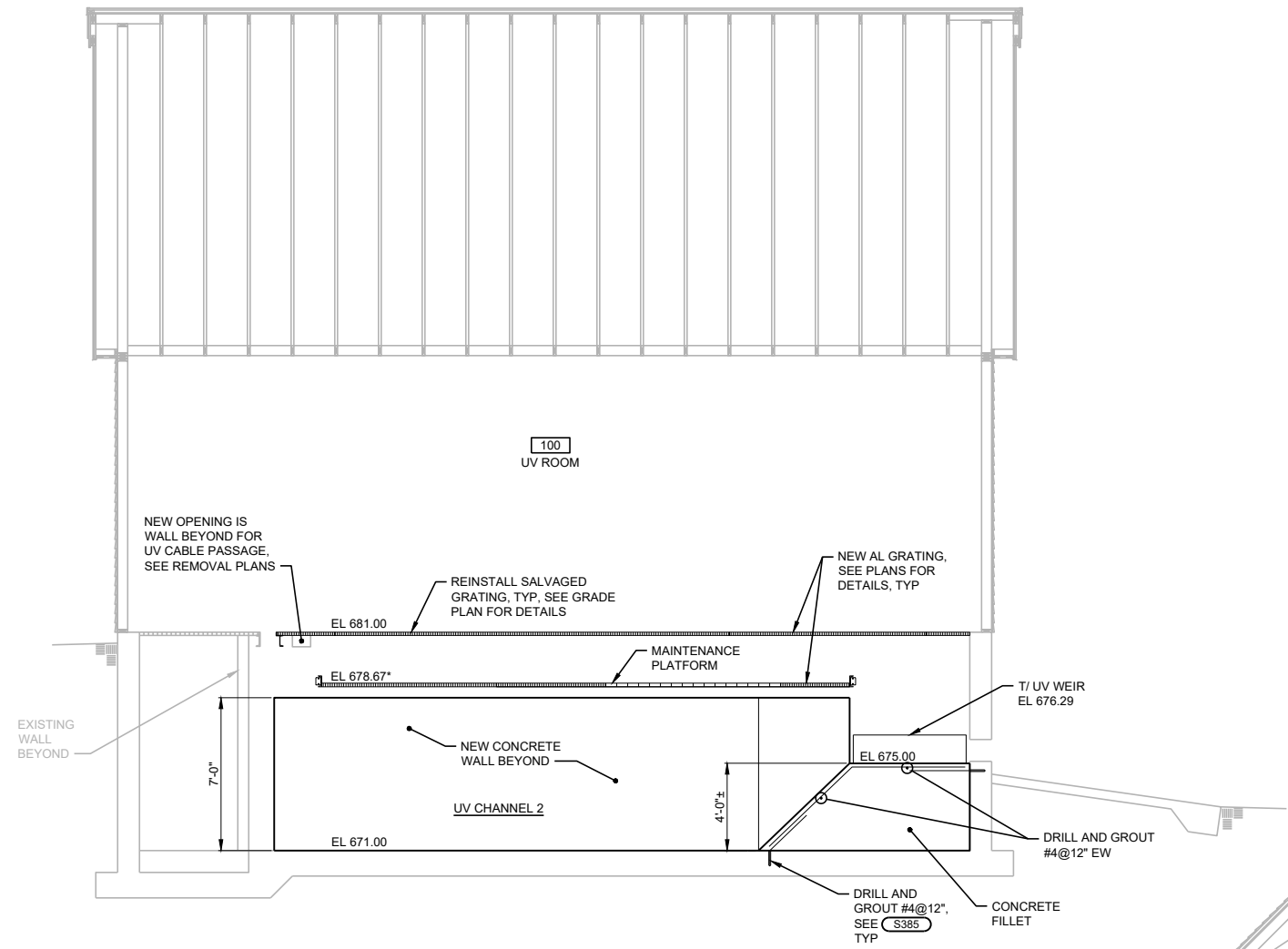

SECTION A
 0 1' 4'
 60-S-1
 60-S-2
 60-S-3

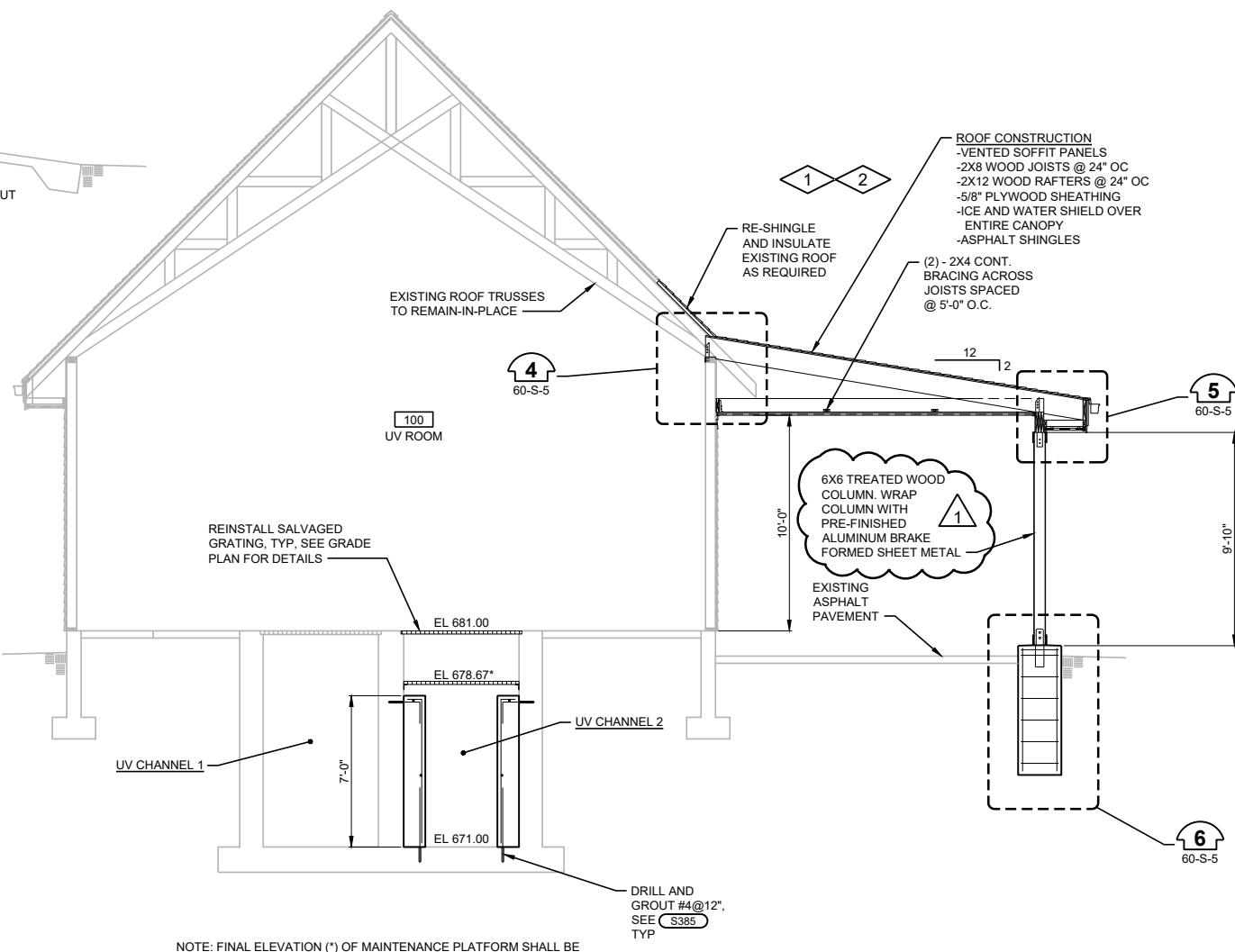

SECTION B
 0 1' 4'
 60-S-1
 60-S-2
 60-S-3

GENERAL NOTES:

1. CONTRACTOR TO FIELD VERIFY EXISTING CONDITIONS, DIMENSIONS, AND ELEVATIONS PRIOR TO CONSTRUCTION AND/OR FABRICATION.
2. REFER TO 001 SERIES OF DRAWINGS FOR THE SPACE ENVIRONMENT/HAZARDOUS RATING SCHEDULE REGARDING ENVIRONMENTAL CONDITIONS ANTICIPATED WITHIN EACH SPACE AND ALLOWABLE MATERIALS OF CONSTRUCTION TO BE USED WITHIN EACH SPACE.
3. ALL REINFORCEMENT SHOWN #4@12" UNLESS NOTED OTHERWISE.

PLAN NOTES:

1. IF OWNER ACCEPTS ALTERNATE 1, PROVIDE ALL WORK ASSOCIATED WITH CANOPY ON EAST SIDE OF BUILDING.
2. ALL STRUCTURAL MEMBERS ASSOCIATED WITH CANOPY ON THIS SHEET SHALL BE OF WOOD CONSTRUCTION WITH SIMPSON STRONG-TIE CONNECTIONS OR EQUAL. SEE SPECIFICATION SECTION 06 10 00 FOR DETAILS.

Date	12/05/2023
Checked By	WJR
Drawn By	CDP
Revision Number	01
Revision Description	ADDENDUM NO. 1
Designed By	CDP
Drawn By	CDP
Checked By	SDR
Approved By	SDR
Filename	60SS1.DWG
Project No.	14206
Project Date	OCT 2023

LAKE COUNTY DEPT. OF PUBLIC WORKS
 MILL CREEK WRF
 UV DISINFECTION REPLACEMENT
 OLD MILL CREEK, IL
 UV DISINFECTION BUILDING SECTIONS



Sheet No. 27
 Drawing No.

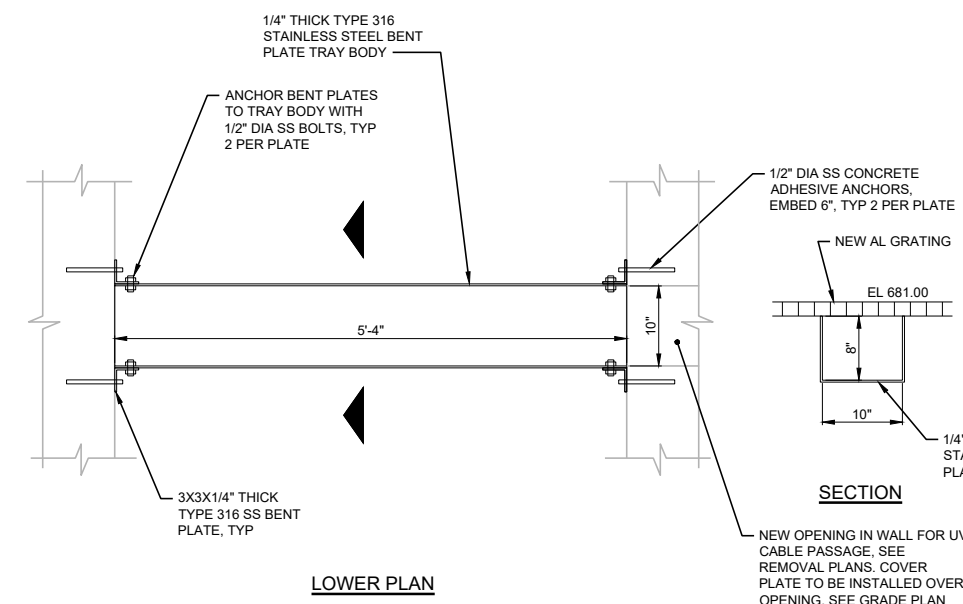

LOWER PLAN

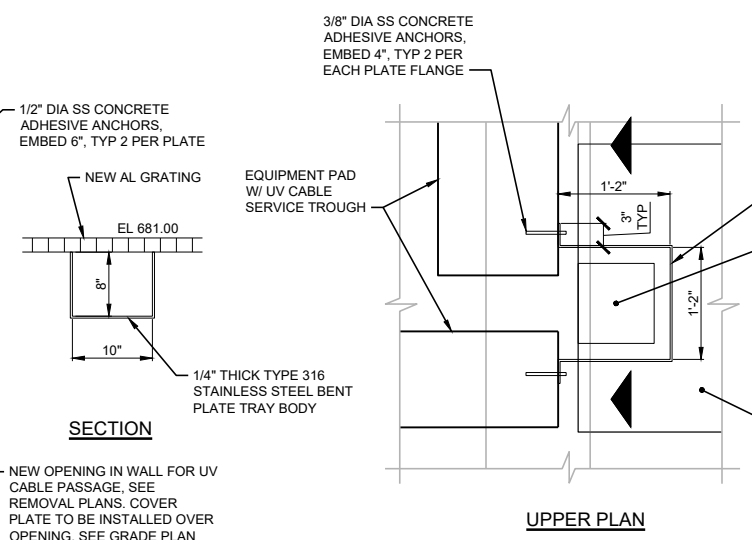

UPPER PLAN

NOTE: COORDINATE DEPTH AND WIDTH OF CABLE TRAY WITH UV MANUFACTURER PRIOR TO FABRICATION. FIELD VERIFY INSTALLATION LOCATION OF CABLE TRAY.

UV CABLE TRAY DETAIL 3
60-S-1
60-S-2

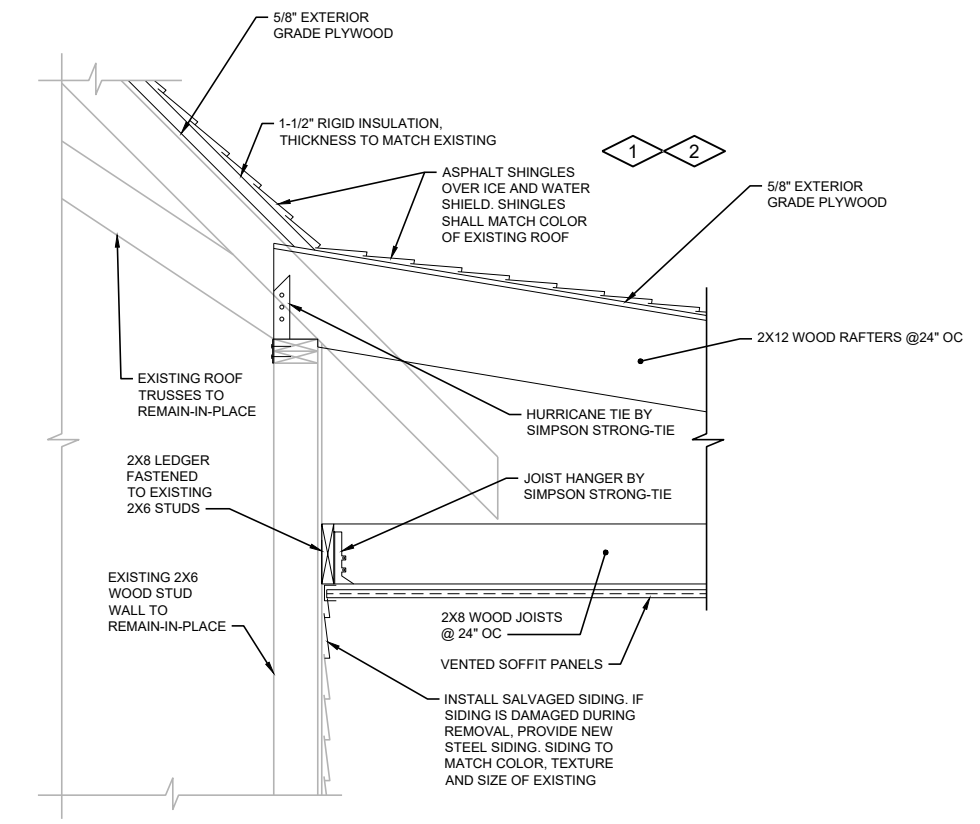

CANOPY CONNECTION TO EXISTING BUILDING WALL 4
60-S-4

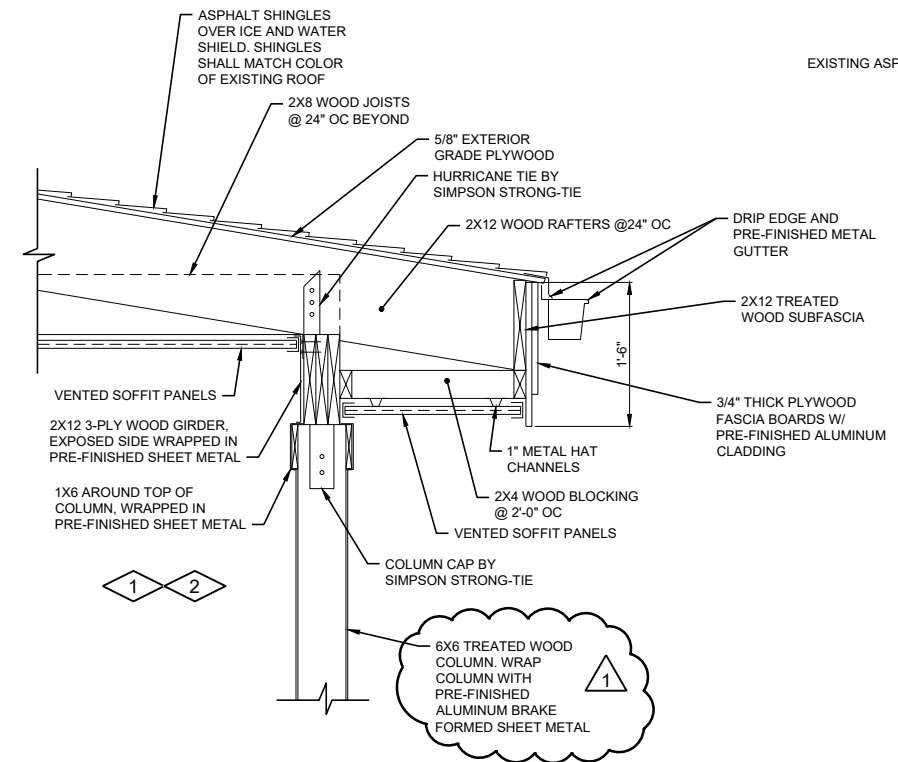

CANOPY ROOF EDGE DETAIL 5
60-S-4

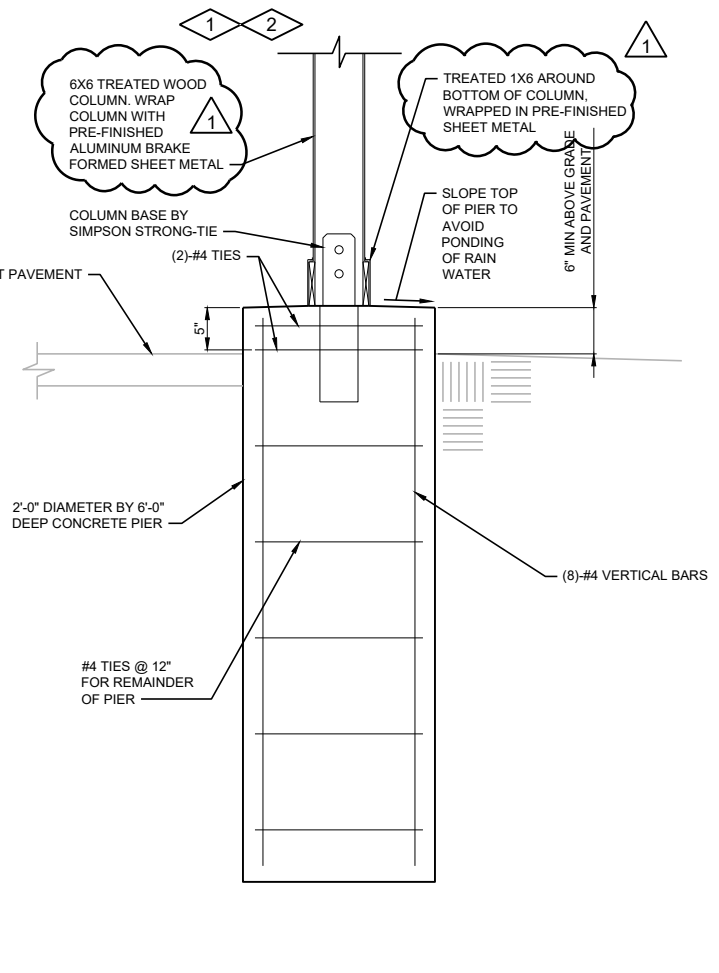

CANOPY COLUMN BASE AND CONCRETE PIER DETAIL 6
60-S-4

GENERAL NOTES:

1. CONTRACTOR TO FIELD VERIFY EXISTING CONDITIONS, DIMENSIONS, AND ELEVATIONS PRIOR TO CONSTRUCTION AND/OR FABRICATION.
2. REFER TO 001 SERIES OF DRAWINGS FOR THE SPACE ENVIRONMENT/HAZARDOUS RATING SCHEDULE REGARDING ENVIRONMENTAL CONDITIONS ANTICIPATED WITHIN EACH SPACE AND ALLOWABLE MATERIALS OF CONSTRUCTION TO BE USED WITHIN EACH SPACE.
3. ALL SIDING, FLASHING, SHEET METAL, SOFFIT AND FASCIA, DRIP EDGES, AND GUTTERS AND DOWNSPOUTS SHALL BE WHITE TO MATCH EXISTING BUILDING COLOR.

PLAN NOTES:

1. IF OWNER ACCEPTS ALTERNATE 1, PROVIDE ALL WORK ASSOCIATED WITH CANOPY ON EAST SIDE OF BUILDING.
2. ALL STRUCTURAL MEMBERS ASSOCIATED WITH CANOPY ON THIS SHEET SHALL BE OF WOOD CONSTRUCTION WITH SIMPSON STRONG-TIE CONNECTIONS OR EQUAL. SEE SPECIFICATION SECTION 06 10 00 FOR DETAILS.

Date	12/05/2023
Checked By	WJR
Drawn By	CDP
Revision Description	ADDENDUM NO. 1
Revision Number	01
Designed By	CDP
Drawn By	CDP
Checked By	SDR
Approved By	SDR
Filename	60SS1.DWG
Project No.	14206
Project Date	OCT 2023

LAKE COUNTY DEPT. OF PUBLIC WORKS
MILL CREEK WRF
UV DISINFECTION REPLACEMENT
OLD MILL CREEK, IL
UV DISINFECTION BUILDING
DETAILS



Sheet No. 28
Drawing No.

REINSTALL EXISTING LIGHTNING ROD CABLES AND REROUTE AS REQUIRED AFTER CANOPY WORK IS COMPLETE

EXISTING LIGHTNING ROD, TYP

ALUMINUM GUTTER AND DOWNSPOUT, TYP

4X4 KNEE BRACES WRAPPED IN ALUMINUM BRAKE FORMED SHEET METAL, TYP

CONCRETE SPLASH BLOCK, TYP

CONCRETE PIER, TYP

EAST ELEVATION

0 1' 4'

ASPHALT SHINGLES, COLOR TO MATCH EXISTING ROOF

3/4" THICK PLYWOOD FASCIA BOARDS W/ PRE-FINISHED ALUMINUM CLADDING

6X6 TREATED WOOD COLUMN. WRAP COLUMN WITH PRE-FINISHED ALUMINUM BRAKE FORMED SHEET METAL, TYP

1X6 AROUND TOP AND BOTTOM OF COLUMN, WRAPPED IN PRE-FINISHED SHEET METAL, TYP. BOTTOM 1X6 SHALL BE TREATED LUMBER.

EXISTING ASPHALT PAVEMENT

VERTICAL STEEL SIDING, SOFFIT AND FASCIA TO REMAIN IN PLACE

DECORATIVE SUPPORTS TO REMAIN IN PLACE

LIGHT TO REMAIN IN PLACE

NEW HORIZONTAL SIDING AND RELATED ACCESSORIES, TYP. COLOR AND SHAPE TO MATCH EXISTING

DOOR AND FRAME TO REMAIN IN PLACE

RECEPTACLES TO REMAIN IN PLACE

ELECTRICAL BOXES TO REMAIN IN PLACE

SOUTH ELEVATION

0 1' 4'

REINSTALL EXISTING LIGHTNING ROD CABLES AND REROUTE AS REQUIRED AFTER CANOPY WORK IS COMPLETED IF ALTERNATE 1 IS ACCEPTED

BASE BID ALTERNATE 1

HORIZONTAL STEEL SIDING, COLOR AND SHAPE TO MATCH EXISTING SIDING. LAP AND TIE NEW SIDING FROM CANOPY INTO EXISTING SIDING ON NORTH FACE OF BUILDING (NOT SHOWN)

ASPHALT SHINGLES, COLOR TO MATCH EXISTING ROOF

PRE-FINISHED 3/4" THICK PLYWOOD FASCIA BOARDS AND PRE-FINISHED ALUMINUM CLAD FASCIA

ALUMINUM GUTTER AND DOWNSPOUT, TYP

NEW CORNER TRIM, TYP

1X6 AROUND TOP AND BOTTOM OF COLUMN, WRAPPED IN PRE-FINISHED SHEET METAL. BOTTOM 1X6 SHALL BE TREATED LUMBER

OVERHEAD COILING DOOR. COLOR TO BE GREEN TO MATCH EXISTING DOORS ON SITE

CONCRETE PIER

EXISTING ASPHALT PAVEMENT

6X6 TREATED WOOD COLUMN. WRAP COLUMN WITH PRE-FINISHED ALUMINUM BRAKE FORMED SHEET METAL

CONCRETE SPLASH BLOCK

LOUVER, SEE H DRAWINGS FOR ADDITIONAL DETAILS

GENERAL NOTES:

1. CONTRACTOR TO FIELD VERIFY EXISTING CONDITIONS, DIMENSIONS, AND ELEVATIONS PRIOR TO CONSTRUCTION AND/OR FABRICATION.
2. REFER TO 001 SERIES OF DRAWINGS FOR THE SPACE ENVIRONMENT/HAZARDOUS RATING SCHEDULE REGARDING ENVIRONMENTAL CONDITIONS ANTICIPATED WITHIN EACH SPACE AND ALLOWABLE MATERIALS OF CONSTRUCTION TO BE USED WITHIN EACH SPACE.
3. ALL SIDING, FLASHING, SHEET METAL, SOFFIT AND FASCIA, DRIP EDGES, AND GUTTERS AND DOWNSPOUTS SHALL BE WHITE TO MATCH EXISTING BUILDING COLOR.
4. NEW HORIZONTAL SIDING SHALL BE PAINTED GALVANIZED STEEL, ROLL FORMED ON SITE. DUTCHLAP, 10" HIGH WITH THREE RIBS, WOOD GRAIN TEXTURE. CONTRACTOR SHALL FIELD VERIFY EXISTING SIDING COLOR, SIZE, SHAPE AND TEXTURE PRIOR TO FABRICATION. NEW SIDING SHALL MATCH EXISTING.

1

PLAN NOTES:

1. IF OWNER ACCEPTS ALTERNATE 1, PROVIDE ALL WORK ASSOCIATED WITH CANOPY ON EAST SIDE OF BUILDING.

Revision Number	Revision Description	Checked By	Date
01	ADDENDUM NO. 1	WJR	12/05/2023

Designed By	CDP
Drawn By	CDP
Checked By	SDR
Approved By	SDR
Filename	60SS1.DWG
Project No.	14206
Project Date	OCT 2023

LAKE COUNTY DEPT. OF PUBLIC WORKS
MILL CREEK WRF
UV DISINFECTION REPLACEMENT
OLD MILL CREEK, IL
UV DISINFECTION BUILDING
ELEVATIONS



Sheet No. 29
Drawing No.

60-S-6